



CORPORATE & PRIVATE HIRE FACILITIES



AT THE HOP FARM-KENT'S LANDMARK EVENTS VENUE

www.thehopfarm.co.uk/corporate



Hospitality
Aerial Adventures
Board Meetings Quad Biking
Stag Parties Charity Balls
Drinks Reception Teambuilding
Anniversary Parties Exhibitions
Activity Days Ladies Nights
Birthday Parties School Prom
Gala Dinner Christening Parties
Awards Ceremonies Training Events AGM's
Country Pursuits Laser Clay Pigeon Shooting
Meetings Ride N' Drives Corporate Hospitality
Product Launches Baby Naming Ceremonies
Family Fun Days Christmas Parties
Conferences Engagement Parties Hen Parties
Dinner Dances Trade Sale Events

THE ROUNDELS

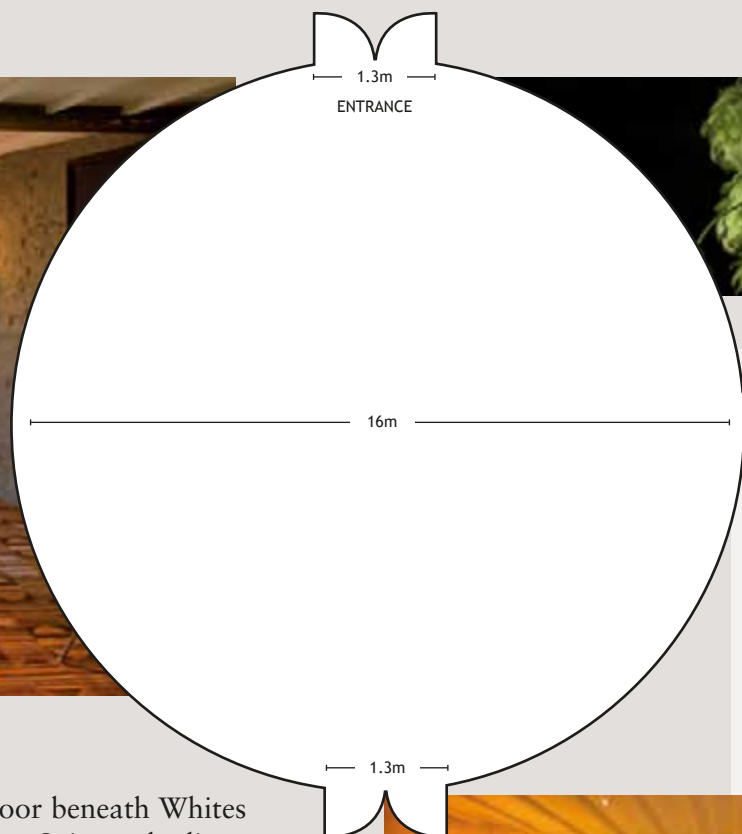

SEATING ARRANGEMENTS

THEATRE STYLE	25
BANQUET/ CABARET STYLE	20
BOARDROOM	20
U SHAPE	15
BUFFET STYLE	25
STANDING RECEPTION	40



Situated on the ground floor beneath Whites Conference & Banqueting Suite and adjacent to The Shires, The Roundels are ideal for small meetings / conferences or as breakout rooms for events held in Whites.

They are two delightful interconnecting oast roundels which work perfectly as one area for the business part of an event, and then a separate area to enjoy lunch and refreshments.



WHITES CONFERENCE & BANQUETING SUITE

SEATING ARRANGEMENTS

THEATRE STYLE	175
BANQUET/ CABARET STYLE	150
BOARDROOM	60
U SHAPE	50
BUFFET STYLE	190
STANDING RECEPTION	250

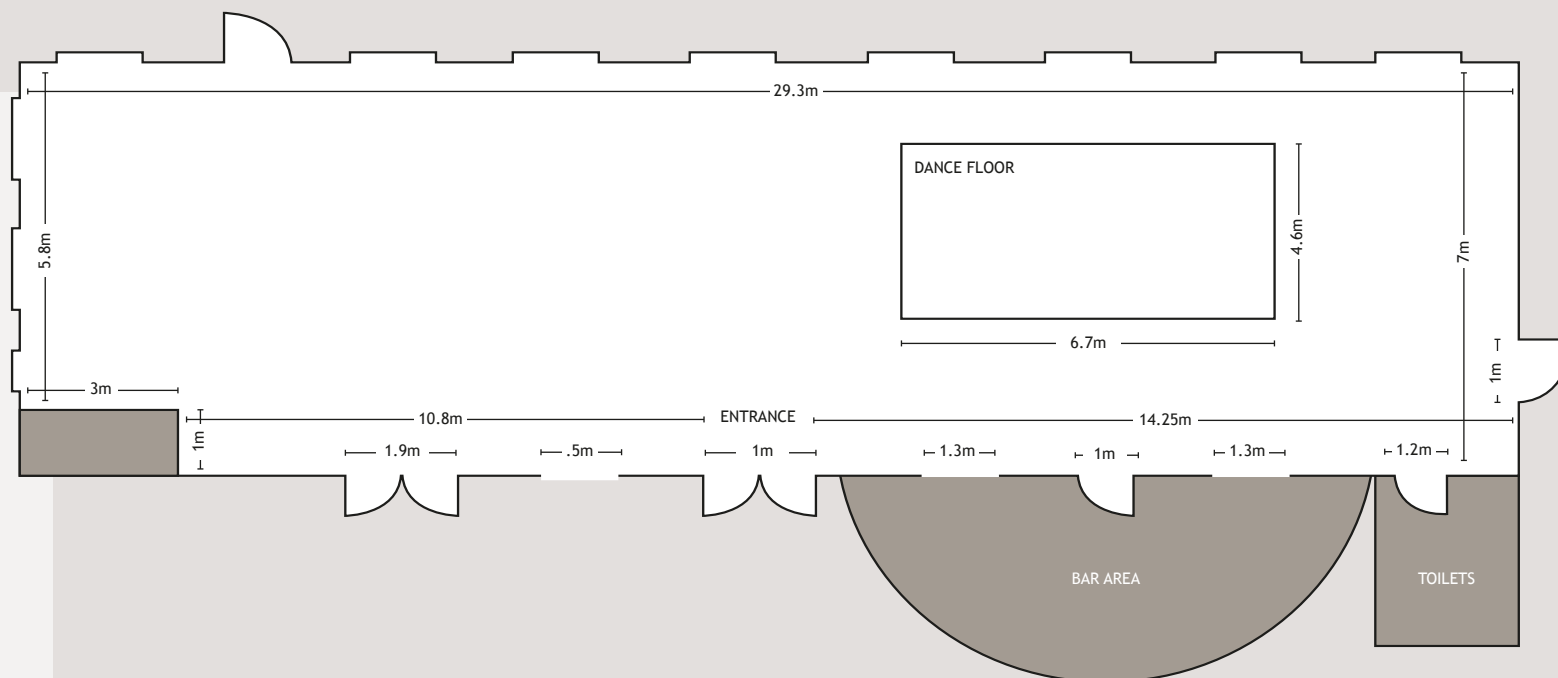

Oak beamed, hop garlanded and flooded with natural daylight, Whites is an impressive and versatile room housed in a tastefully converted and recently refurbished oast house. This attractive first floor room can play host to a variety of functions, from a conference for 30-100 delegates through to a dinner for 150 guests or a drinks reception for 250.

Whites has its own integral bar situated in the kiln area of the oast house plus a dance floor and reception area.

The room also has a stair lift to provide disabled access.

THE SHIRES (EVENINGS AND OFF-PEAK SEASON ONLY)



SEATING ARRANGEMENTS

BANQUET/ CABARET STYLE	90
BOARDROOM	30
U SHAPE	30
BUFFET STYLE	150
STANDING RECEPTION	200

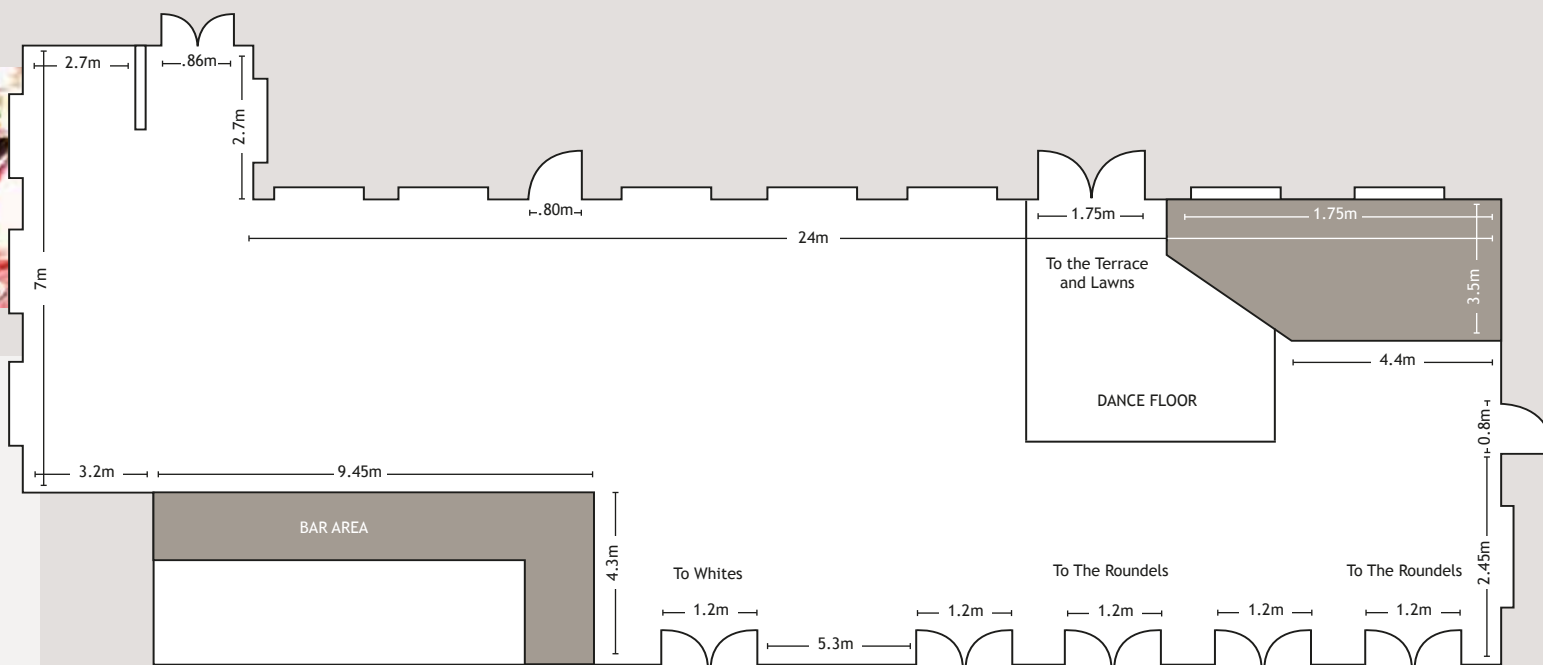

Situated on the ground floor beneath Whites Conference & Banqueting Suite, The Shires is a relaxed, pub style function area. Ideal for informal events and parties or can also be used as a practical extension for larger parties in Whites. The room boasts a full bar area and a delightful outdoor terrace area.



THE DRAY

The Dray is one of the few function rooms in Kent able to accommodate up to 320 guests seated theatre style for a conference.

It is also the ideal venue for large private parties, school proms or family fun days as it has a standing capacity of up to 450 guests.

Having recently been refurbished, The Dray offers a 40' bar, full disabled access and toilet facilities, and the opportunity to host much larger events when teamed up with the adjoining Dray Marquee.

The Dray is a much sought after, versatile function room that can be hired with or without Hop Farm catering and also offers the opportunity for clients to provide their own catering.

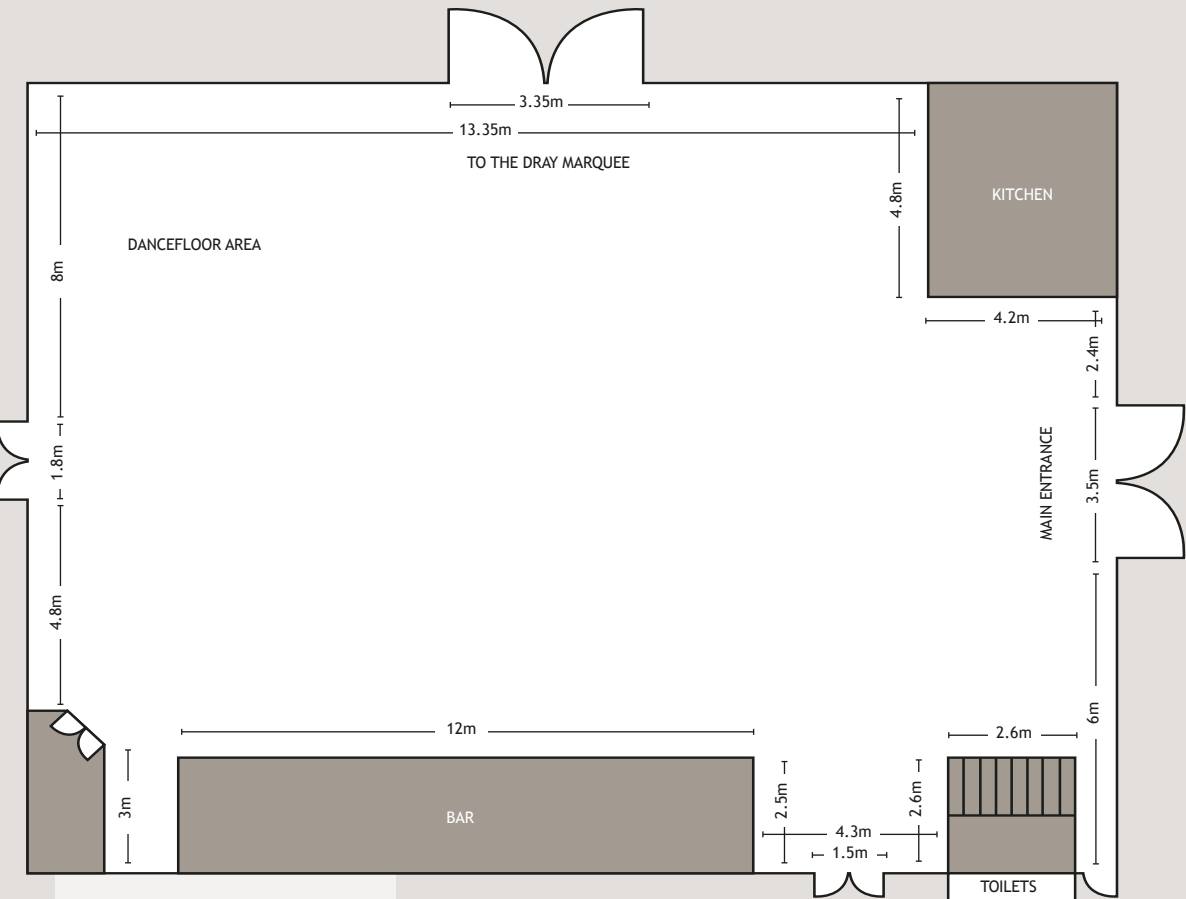

SEATING ARRANGEMENTS

THEATRE STYLE	320
BANQUET/ CABARET STYLE	250
BOARDROOM	84
U SHAPE	63
BUFFET STYLE	350
STANDING RECEPTION	450



THE DRAY MARQUEE (TO BE HIRED IN CONJUNCTION WITH THE DRAY ONLY)



SEATING ARRANGEMENTS

THEATRE STYLE	340
BANQUET/CABARET STYLE	275
BOARDROOM	90
U SHAPE	66
BUFFET STYLE	350
STANDING RECEPTION	450

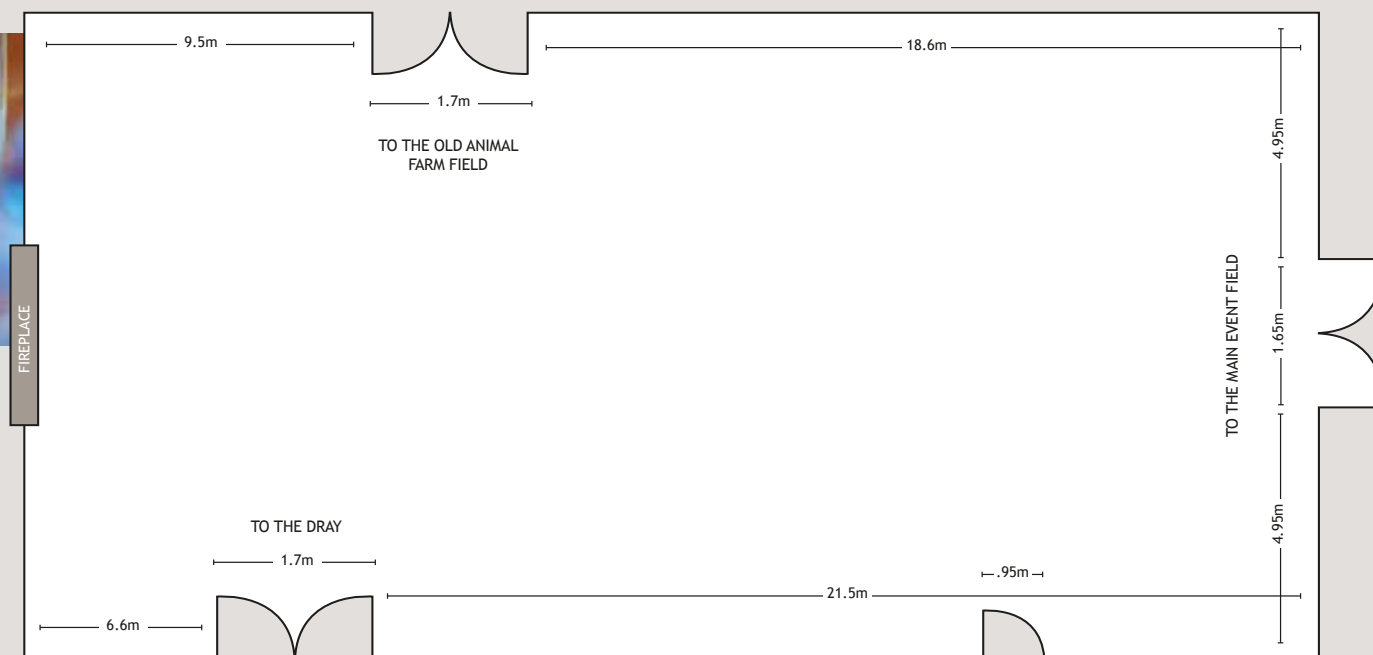

Permanently attached to The Dray, The Dray Marquee offers an additional 360 square metres of space. The marquee has been fitted out with wooden interior walls and fully carpeted, in order to create a usable, permanent room. Ideally used in conjunction with The Dray, the Dray Marquee provides a perfect area for catering and refreshments for large conferences or alternatively can house a wide variety of trade stands for exhibition clients.

For large parties or dinner dance events, up to 275 guests can be seated to dine in The Dray Marquee, leaving The Dray clear as an area for the bar and dance floor.



THE LAND

The Hop Farm boasts over 500 acres of flat event fields including a challenging 4x4 course and large arena for the more dangerous spectator sports. As an established touring site, there are toilet and shower blocks and ample space for corporate camping events.

This is the ideal venue for all corporate activities and team building days. The Hop Farm can hire its clients just the field space needed for an event, or the Corporate Team can actively organize an exciting range of activities to suit all group sizes, budgets and requirements. For those who enjoy motorized activities there are quad bikes, 4x4 driving, blindfold driving and reverse steer driving, or for those with their feet planted firmly on the ground we can organize laser clay pigeon shooting, archery, target pistol shooting or target golf. Equally, some people just want to have fun, and The Hop Farm can offer giant sumo wrestling, bungee running, gladiator jousting, human table football, human gyroscope, a wide range of children's and adult bouncy castles and even the classic fun event "It's A Knockout".

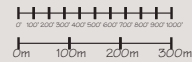
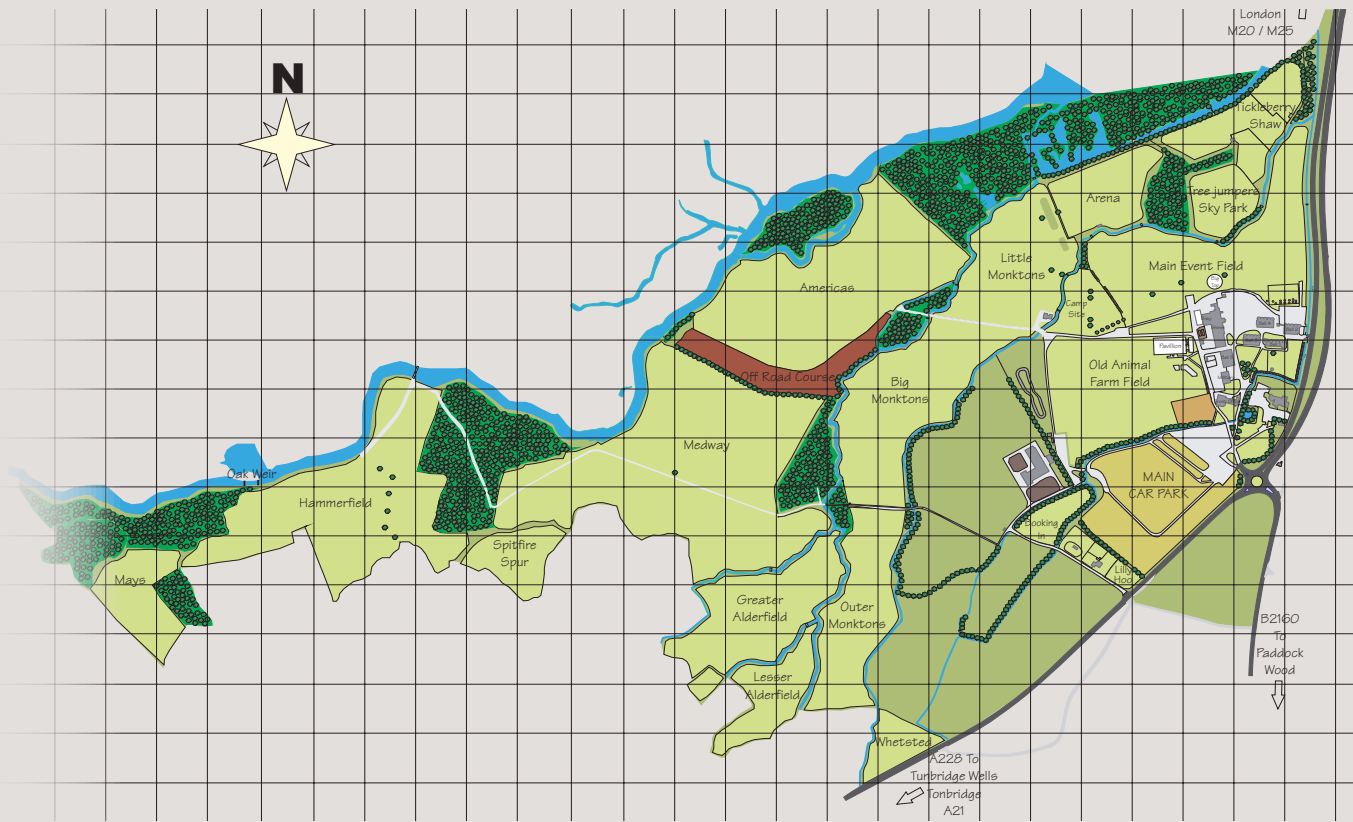

ACREAGE

MAIN EVENT FIELD:	20 ACRES
LITTLE MONKTONS:	13 ACRES
BIG MONKTONS:	17 ACRES
OLD ANIMAL FARM FIELD:	17 ACRES
AMERICAS:	24 ACRES

TESTIMONIALS



THE DRAY - VALENTINES BALL - THE AVENUES GROUP

"The night was absolutely fantastic! Everyone thoroughly enjoyed themselves. It went superbly."



BLACKSMITHS & HORSESHOES - COMPANY ANNIVERSARY PARTY - GREENWICH TOY LIBRARY

"Thank you and your staff for all of the hard work you put into our event. The feedback that I got from everyone was that they enjoyed every minute. The food was fab and the rooms were lovely. All had a great time so once again a big thank you."

BLACKSMITHS - COMPANY FAMILY FUN DAY - TAYLOR WIMPEY

"May I just thank you and everyone concerned for making Saturday such a huge success. The food was superb and obviously the glorious weather just finished everything off. I am sure you will be seeing us again!"



BLACKSMITHS - 30TH BIRTHDAY PARTY - BECCI WOOD

"Thanks so much for your help on the lead up to my party! Everyone had a fantastic night including me! The food was fantastic. Thanks again."



WHITES & THE SHIRES - CONFERENCE - RICS

"Thank you for organising yesterday so smoothly for us. We were extremely happy with how the conference went and we have had some very positive comments about the venue from our delegates. The catering was excellent and the Banqueting Manager deserves a special mention as she was always available to help me and made the day all the more pleasurable."



THE ROUNDELS - MEETING - CANCER RESEARCH

"Just like to thank you for ensuring we had a great day out! Your staff were spot on and could not have been more helpful over the arrangements that were made - the rooms were great and made things just a little bit different."

WHITES & LAWNS - FAMILY FUN DAY - ANTHONY ROWCLIFFE & SONS

"The staff were excellent and very helpful. The area we had was excellent. In general the event was hugely successful, we have had nothing but positive comments about it. Thank you so much to you and your team for the excellent organisation involved in this."

LOCATION

The Hop Farm is conveniently situated between Maidstone and Tunbridge Wells on the A228, approximately 20 minutes from the M20 and 25 minutes from the M25. The mainline station of Paddock Wood is 1 mile away and is on a direct link from London Bridge, Waterloo and Charing Cross. The train journey from London takes approximately 45 minutes. The Hop Farm has on site parking for more than 3000 cars.

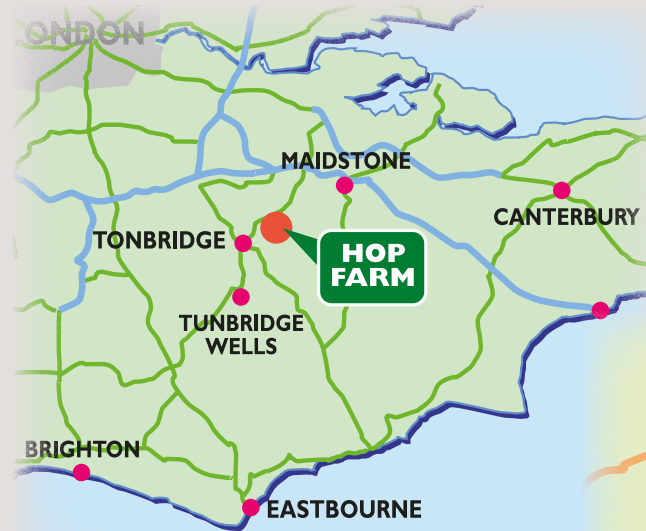



AT THE HOP FARM - KENT'S LANDMARK EVENTS VENUE

www.thehopfarm.co.uk/corporate